

L-Banner Express



Set-up Instruction

Mobile display "L-Banner Express" is very simple to use in various expositions, conferences, presentations of new products, seminars and offices. Compact, light-weight. Very easy to assemble (few minutes are enough) and to move.

Product Information

| | |
|---------------------|--------------------------------------|
| Graphic size (mm) | 600 x 1600 600 x 1800 |
| Packaged weight | 0.5Kg, |
| Material | aluminium alloy, plastic |
| Package | 610 x 1630 x 390 610 x 1830 x 390 |

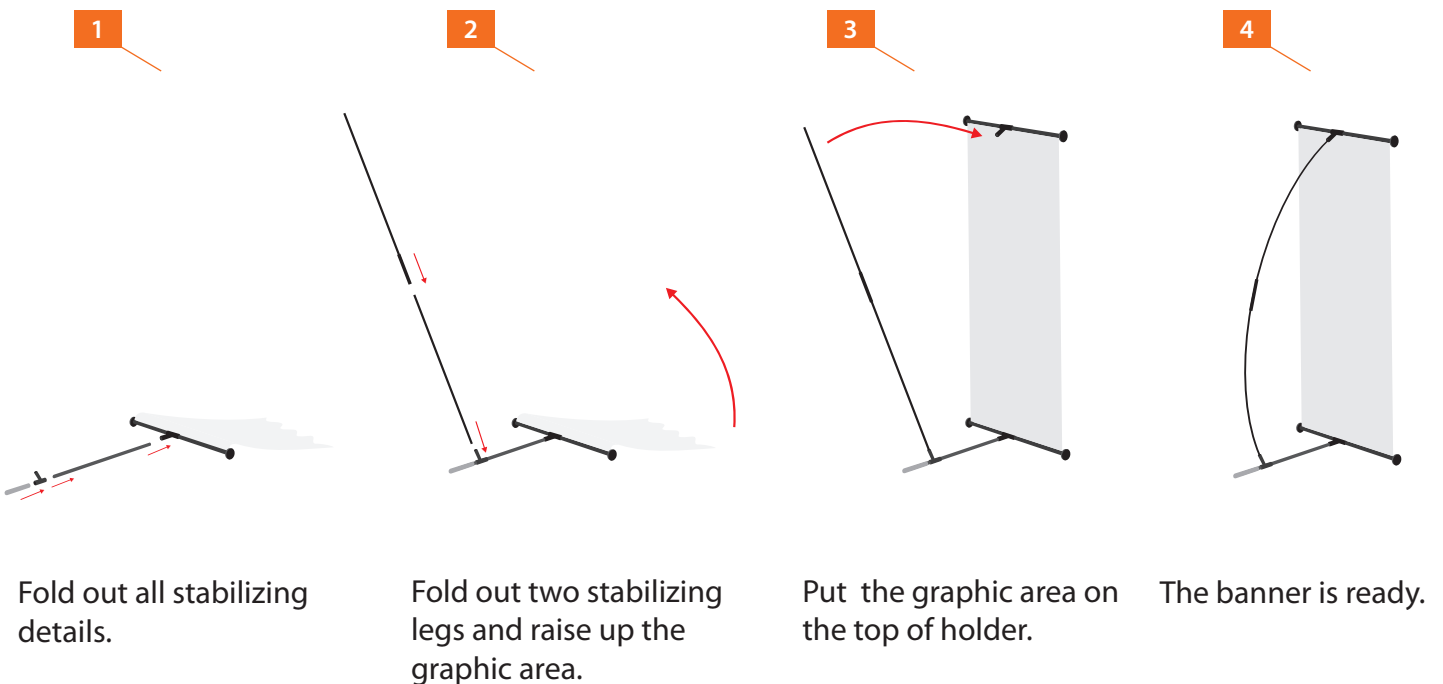

Fold out all stabilizing details.

Fold out two stabilizing legs and raise up the graphic area.

Put the graphic area on the top of holder.

The banner is ready.

L-Banner Express

Graphic Specification

These are guidelines for preparing ready printing files

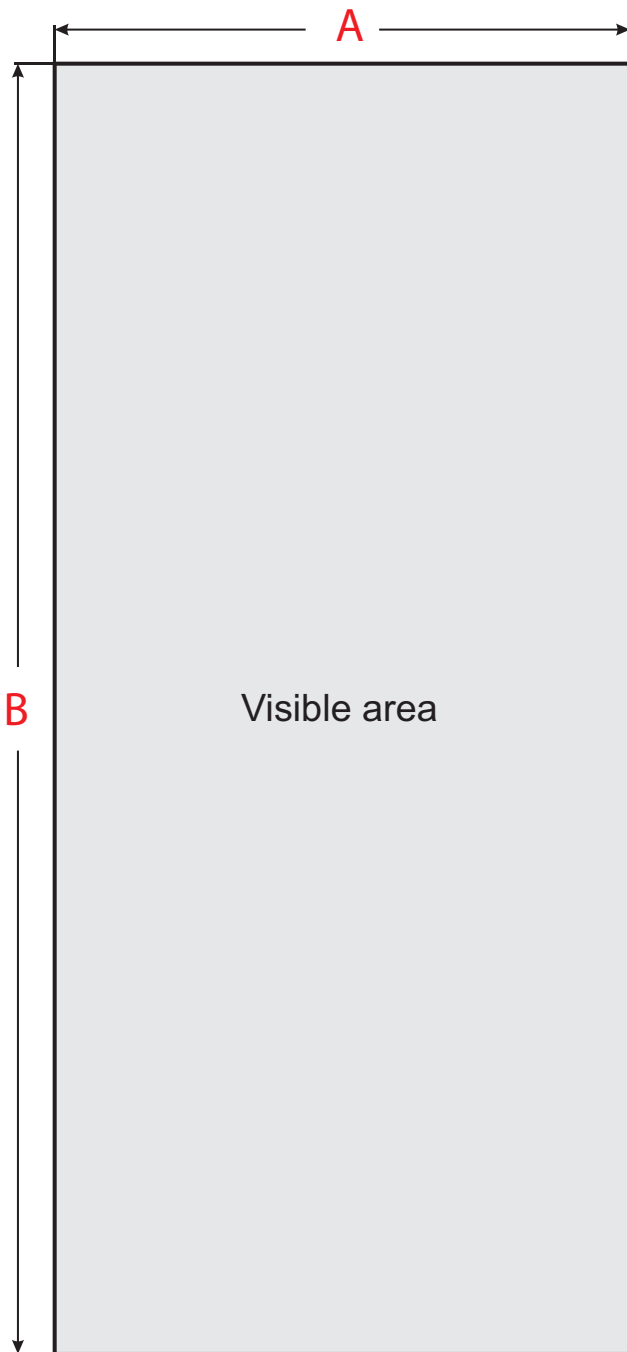

Artwork Guidelines

| | |
|--------------------------------|--------------------------|
| Visible graphic size (A x B) | 600 x 1600 600 x 1800 |
|--------------------------------|--------------------------|

Artwork Requirements

| | |
|-----------------------------|-------------|
| Resolution | 100-150 dpi |
| Color mode | CMYK |
| File format (scale M 1:1) | .TIFF |

Recommendations

Keep all important graphic elements (images, text, etc.) within the visible area.

Please allow space for trimming by not placing type or logos too close to the edge of the visible area.