

Set-up Instruction



At last, a simple to use robust and effective landscape banner kit, lightweight and easy to use too. The GiantFrame outdoor banner frame is made from lightweight aluminium that is ideal for use with PVC eyelet banners, it is reusable and is the perfect graphics carrier for venues, events, exhibitions, promotions and indoor or outdoor shows and is rapidly becoming the outdoor banner of choice.

Product Information

Graphic size (mm)	2840 x 1090
Packaged weight	< 9Kg,
Material	aluminium alloy, plastic

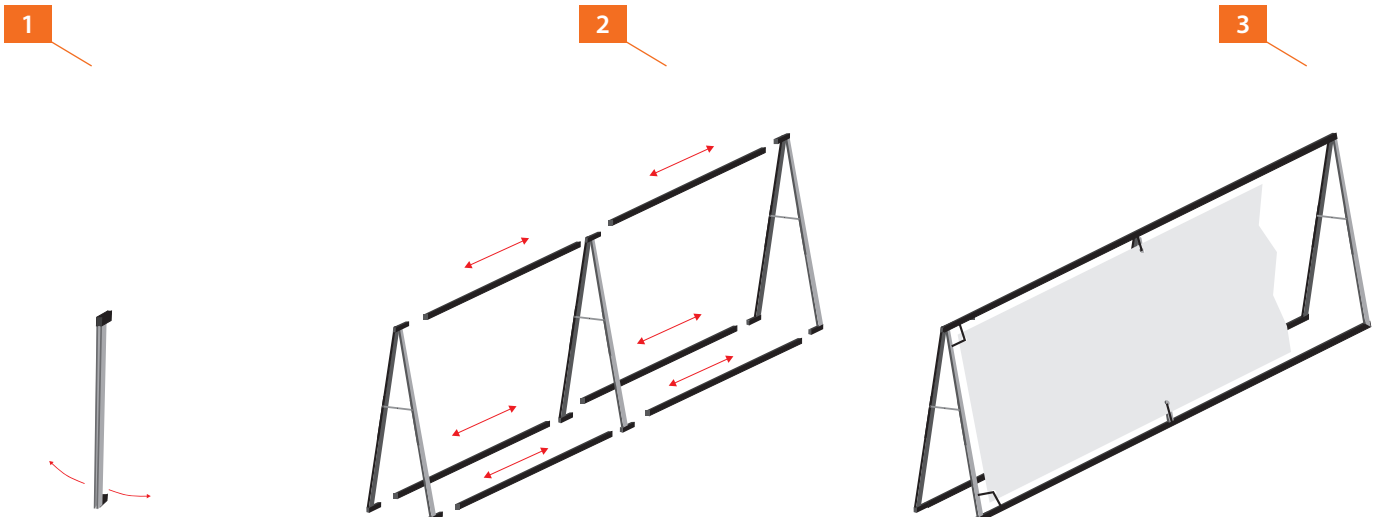

1
Remove pop up frame
from carry bag.
Fold out the board legs.

3
Connect graphic holders.
Add the graphic in the
front. The board is ready.

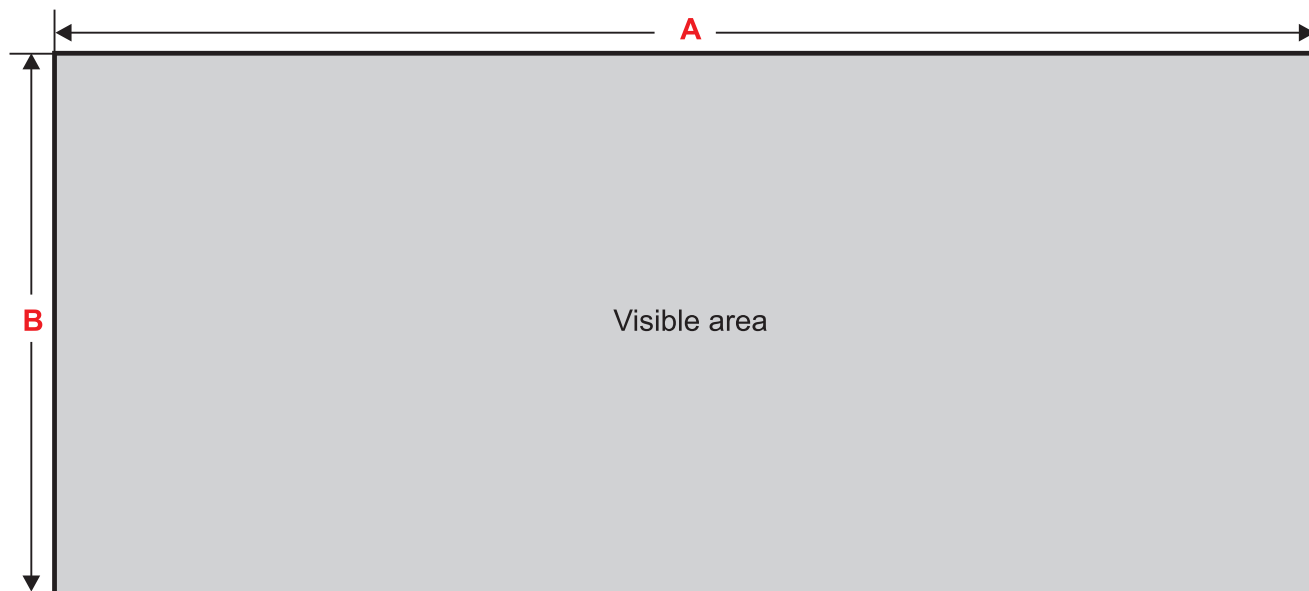

Graphic Specification

Recommendations

Keep all important graphic elements (images, text, etc.) within the visible area.

Please allow space for trimming by not placing type or logos too close to the edge of the visible area.

These are guidelines for preparing ready printing files

Artwork Guidelines

Visible graphic size (**A x B**) **2840 x 1090**

Artwork Requirements

Resolution **100-150 dpi**

Color mode **CMYK**

File format (scale M 1:1) **.TIFF**